

# Centennial Towers Room Specifications

## Closet Specifications

- Closet measures 32"d x 53"w x 85"h
- Closet bar measures 53"w.
- Top shelf measures 18"d x 53"w x 14.5"h



## Dresser Specifications

- Dresser measures 18"d x 29.5"w x 52"h
- Each of the six drawers are the same size measuring 14.5"d x 26.5"w x 5"h



## Desk Specifications

- Desk measures 24"d x 32.25"w x 30.25"h
- Drawer measures 21"d x 29"w x 1.5"h



## End Table Specifications

- End table measures 24"d x 17"w x 30"h
- Drawer measures 20.5"d x 14"w x 5"h
- Cabinet measures 22"d x 15"w x 17.25"h
- A personal padlock may be added for security

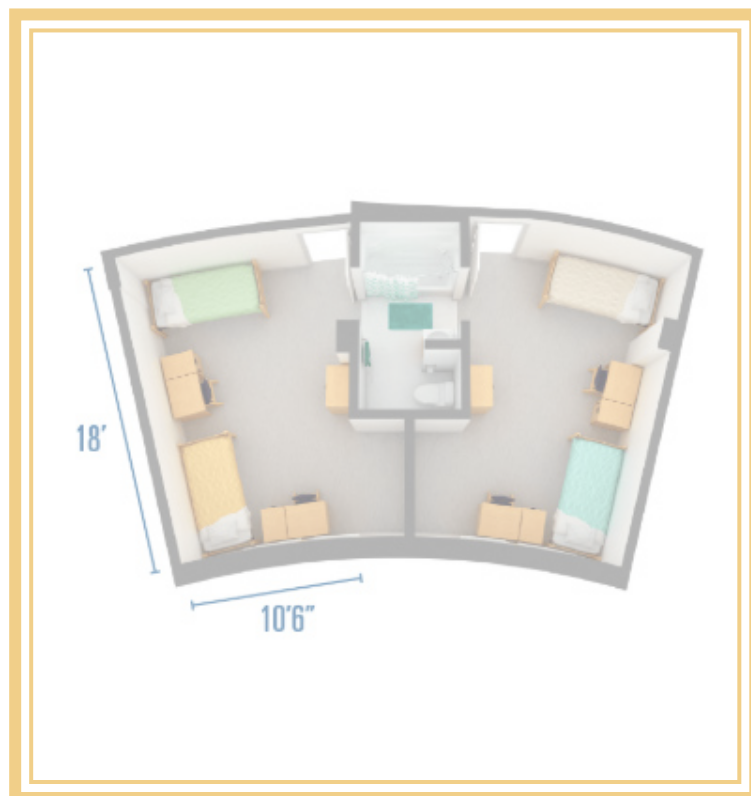

## Room Description

A standard room in Centennial Towers East & West consists of two beds, one dresser, two desks, two chairs, one closet space, and one window.

Information on the bathroom is provided on the back of this page.

## Window Specifications

- Six panel window measures 73"w x 59"h
- Vertical blinds installed in all rooms

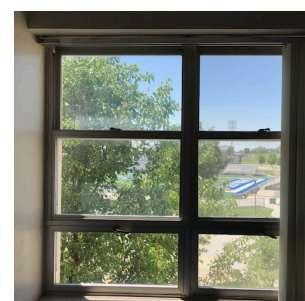

# Centennial Towers Room Specifications

## Bed Specifications

- Bed measures 41”d x 86”w x 36”h
- Can be positioned at 12 different heights
- Slots to adjust height are 3” apart
- Mattress is Twin XL and measures 80” long



## Chair Specifications

- Chair measures 20”w x 32-35”h
- Top of chair can be lifted off for a gaming chair
- Height of chair is adjustable using lever
- Chair is on rolling casters



## Vanity Specifications

- Medicine cabinet above the vanity measures 5.5”d x 24”w x 22.5”h
- Vanity measures 20.5”d x 31”w x 30.5”h
- Cabinet in the vanity measures 19.5”d x 28.5”w x 22.5”h



## Room Description

The bathroom is shared between two suites. The residents in these suites will be of the same gender.

## Shower Specifications

- Bathtub measures 30.5”d x 58.5”w x 15.5”h
- Shower bar measures 58.5”w
- A shower curtain is provided



## Private Toilet Room Specifications

- The overhead storage above the toilet has two shelves and measures 8.5-9.75”d x 28.5”w x 22.5”h
- Top shelf measures 9.75”d x 28.5”w x 11.5”h
- Bottom shelf measures 8.5”d x 28.5”w x 11”h



**For more information on housing  
contact us using the following:**

308-865-8519

housing@unk.edu

unk.edu/housing