



Holdrege Area Early
Childhood Partnership, Inc.
EST. 2024

Holdrege Area Early Childhood Partnership

★ Our Team ★

President: Grant Ericksen (Phelps County Development Corporation)

Vice President: John Poppert (Administrator ESU 11)

Secretary: Holly Rahman (Holdrege Area Chamber of Commerce)

Treasurer: Lindsay Sullivan (Phelps Memorial Health Center)

Board Member: Mark Harell (CEO Phelps Memorial Health Center)

Board Member: Kevin Moriarty (CEO Holdrege Memorial Homes)

Board Member: Jason Sidel (CEO embecta)

Board Member: Joel Pelster (Director of the YMCA)

Executive Director: McKenna Fahrenbruch

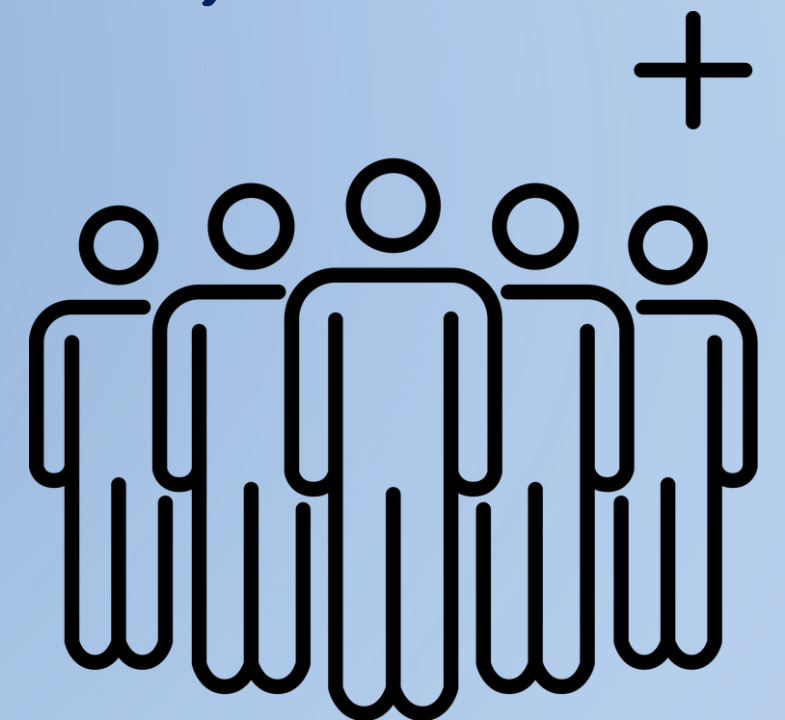



THANK YOU!



For providing the \$500 stipends to the first five child care providers who reach level 3 in Step Up to Quality!

LEARN MORE ABOUT STEP UP TO QUALITY:
WWW.STEPUPTOQUALITY.NE.GOV





PAID COORDINATION WORK:

PART OF THE KNEW
FUNDS GOES INTO THE
OVERALL POT TO
CONTRIBUTE TO THE
FUNDS TO PAY FOR MY
COORDINATION WORK



Autism Training for Childcare Providers

JOIN US:

Saturday April 18th
at 9:00am-11:00am
at ESU 11

412 W 14th Ave, Holdrege, NE 68949
This training is FREE to attend



This FREE training will include:

Information about autism, characteristics of autism, sensory issues that some on the spectrum have, and other areas involving autism. We will provide some tips and suggestions on different ways to help those with autism in the childcare setting. There will also be a Q&A time for attendees to learn more and have any questions or concerns answered.

*two licensing hours provided. There is no registration for this event.

CONTACT US WITH QUESTIONS:
HOLDREGEAREAACP@GMAIL.COM



Thank you to our sponsors!



YOU'RE INVITED!

THANK YOU TO OUR SPONSORS FOR
HELPING US PROVIDE THIS TRAINING AS
WELL AS SUPPLY ATTENDEES WITH A
SENSORY BAG TO TAKE HOME.

←
Thank You



For employers and other contributors

Everybody benefits when we have access to stronger child care options. Access to affordable, quality child care isn't just good for parents raising little ones. It's also good for our statewide workforce, employers, communities and the quality of life we want for all Nebraskans.

The **Child Care Tax Credit for Employers and Other Contributors** encourages Nebraska's private sector to get involved in helping to build the child care infrastructure our state needs to thrive—now, and in the years ahead.

Who is this tax credit for?

The Child Care Tax Credit for Employers and Other Contributors is a nonrefundable credit for taxpaying individuals or entities (such as businesses, trusts, estates, philanthropies and others) who make qualifying contributions that help improve the availability of child care options, especially for families and communities facing serious economic challenges.

The credit can be claimed beginning with state income tax returns for the 2024 tax year.

What's a nonrefundable credit?

Nonrefundable tax credits reduce a taxpayer's tax bill. If the amount of the credit is larger than the tax payer's tax liability, the difference is not refunded.

In the case of the nonrefundable Child Care Tax Credit, the contributor may carry over the unused amount of the credit to the following tax year, but the credit must be completely used within five years of the contribution.

How large is the tax credit?

The Child Care Tax Credit for Employers and Contributors is available in two tiers. For either tier, the total amount of the credit cannot exceed \$100K per year.

Tier 1

100%

Applicants can receive a nonrefundable credit equal to the total qualifying contribution if the contributor benefits child care programs that operate in a Nebraska Opportunity Zone or serve children in need through the child care subsidy.

Tier 2

75%

Applicants can receive a nonrefundable credit equal to 75% of any other qualifying contribution to child care.

What kind of contributions qualify for the nonrefundable tax credit?

To qualify for the nonrefundable Child Care Tax Credit, contributions must be used by the recipient specifically for child care services. Examples of qualifying uses include:

- ▶ Establishing or expanding a child care program
- ▶ Enabling a program to purchase learning materials or play equipment
- ▶ Professional development of child care program staff
- ▶ Child care tuition assistance for families in need
- ▶ Referral services that connect families to child care providers

How are qualifying contributions made?

Contributions can be made by cash, cash equivalent, check, commodities, publicly traded securities and other methods. Please note that in-kind services or properties do not qualify for the tax credit.

Contributions may be made directly to specific child care programs or indirectly through intermediary organizations such as community collaboratives, local development funds and other entities involved in child care initiatives.

When should I apply?

You can submit your application for the nonrefundable Child Care Tax Credit as soon as you've made your qualifying contribution and collected the required documentation. It is not necessary to wait until the end of the tax year to file your application.

Am I guaranteed a tax credit if I make a qualifying contribution?

The Nebraska Legislature has approved \$2.5M per year for the nonrefundable Child Care Tax Credit. When the annual limit is reached, no further nonrefundable Child Care Tax Credits will be issued until the following tax year. The Nebraska Department of Revenue (NDOR) will process applications in the order in which they are received.

DISCLAIMER

First Five Nebraska does not provide financial or tax guidance. Be sure to consult your financial advisor, accountant or tax preparer before making a contribution.

WE HOSTED A TAX INCENTIVE MEETING TO EDUCATE OUR COMMUNITY ABOUT THEIR OPTIONS! THANK YOU MIKE FEEKEN!

How to Apply

STEP 1 DOCUMENT THE CONTRIBUTION

Obtain a completed copy of the **Child Care Tax Credit Contribution Receipt** from the program or entity who received your contribution. The recipient must indicate how your contribution will be used.

STEP 2 SUBMIT THE TAX CREDIT APPLICATION

Use the **Nebraska Department of Revenue (NDOR) website** to submit your completed **Child Care Tax Credit Application form** and **Child Care Tax Credit Contribution Receipt**. You will receive an automated email verifying that your application has been received.

STEP 3 CLAIM THE TAX CREDIT

NDOR requires at least 90 days to review tax credit applications. If your application is approved, you will receive a certification to include with your 2024 state income tax return.

Resources

Nebraska Department of Revenue (NDOR) Child Care Tax Credit Webpage
revenue.nebraska.gov/businesses/child-care-tax-credit-act

- ▶ **Child Care Tax Credit Contribution Receipt form**
- ▶ **Child Care Tax Credit Contribution Application form**
- ▶ **Contributor Authorization Table** (Total amount of nonrefundable Child Care Tax Credits authorized to date for the current tax year: revenue.nebraska.gov/businesses/child-care-tax-credit-contributor-authorization-table)

CULTIVATE A SUCCESSFUL CHILD CARE BUSINESS

6 REGIONS
One Nebraska

BUFFALO COUNTY
community
partners

50+ years of childcare experience from local mentors!



\$2,500
stipend

Experienced Mentors
here to help

Limited Spots
available

GET STARTED NOW

bit.ly/childcarelicense

More info



Available to people living in
Central, NE counties.

Dena R. Beck
dbeck@NEChamber.com
(308) 832-7810

Powered by Buffalo County Community Partners and funded by the State of Nebraska – Department of Economic Development
Regional Development Initiative Program - Contract 225-11-145.

WE HAD TWO IN-HOME
CHILDCARE PROVIDERS GO
THROUGH THIS MENTORSHIP
AND SAID IT WAS AMAZING! WE
CONTINUALLY PROMOTE THIS
PROGRAM.



CHILD CARE CENTER RENOVATION BUDGET

| | | |
|---|--|----------|
| Fire Alarm System | A building-wide fire alarm system to ensure safety and compliance with state regulations. | \$95,000 |
| Construction and Renovations Melroy Construction | Construct a new kitchen equipped with countertops, one handwashing sink, one double-bowl wash sink, a residential stove with vent hood, and designated space for a commercial dishwasher. Build four single-stall bathrooms with handicap accessibility and handwashing sinks. Install fire-rated doors for two rooms in compliance with required state regulations. | \$45,800 |
| Plumbing | All required plumbing for bathrooms and classrooms will be added in accordance with applicable codes and regulations. | \$30,000 |
| Fence and Outdoor Play Area | Install an outdoor play area with a 4 foot fence meeting required state height regulations. | \$4,772 |

Total Renovation Cost: \$175,572

| | | |
|------------------|---|----------|
| Furnishing Rooms | Classrooms will be designed with high-quality furnishings and materials and will include all items required by the state. Each classroom will be equipped to meet the specific needs of its designated age group. | \$10,000 |
| Appliances | This includes the installation of a washer and dryer, as well as a commercial dishwasher. | \$7,000 |

Total Renovations & Start-up Plan: \$192,572

Current outside pic of the building



Capital Campaign Goal: \$192,572

Planting a solid foundation for future growth.
The campaign goal is taking into account the costs to renovate the facility and ensure long term sustainability.



CREATION & MANAGEMENT OF A LOCAL CHILD CARE CENTER

WILL BE IN NEBRASKA STEP UP TO QUALITY PROGRAM

ENSURING QUALITY CARE TO THE COMMUNITY

FUTURE KIDDIE COVE FAMILY CHILDCARE CENTER
1308 2ND ST, HOLDREGE, NEBRASKA 68949

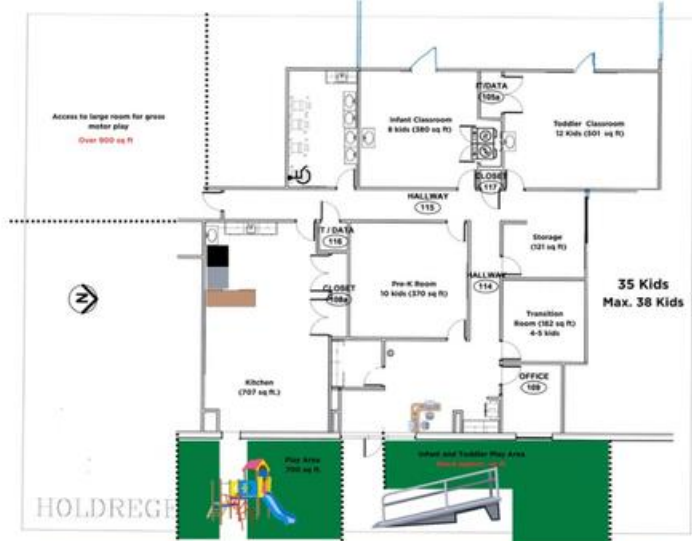

MAKE CHECKS PAYABLE TO:
AG SOCIETY
1308 2ND ST, HOLDREGE, NEBRASKA 68949

QUESTIONS?
CONTACT KENDRA YANEZ
308-991-9194
KIDDIECOVEFAMILY@GMAIL.COM

MORE INFORMATION CAN BE FOUND ON OUR FACEBOOK
[HTTPS://WWW.FACEBOOK.COM/PHELPS.AG.SOCIETY](https://www.facebook.com/pHELPS.AG.SOCIETY)

INDIVIDUAL CONTRIBUTIONS TO 501(C)(3) ORGANIZATIONS ARE NOT TAX DEDUCTIBLE FOR THE DONOR AS CHARITABLE EXPENSES. HOWEVER, 501(C)(3) CONTRIBUTIONS MAY BE TAX DEDUCTIBLE FOR INDIVIDUALS IF THEY QUALIFY AS "ORDINARY AND NECESSARY" BUSINESS EXPENSES, SUCH AS LABOR UNION DUES.

ONE OF THE IN-HOME CHILDCARE PROVIDERS IS CURRENTLY BEING MENTORED BY A LARGE CENTER PROVIDER TO OPEN UP A NEW CHILDCARE CENTER THAT WILL OPEN SOON FOR ABOUT 38-45 CHILDREN! IT'S BEEN SO FUN TO SEE OUR COMMUNITY COME TOGETHER TO MAKE THIS PROJECT HAPPEN!

Programs Preview

HOLDREGE AREA EARLY CHILDHOOD PARTNERSHIP

INFANT INCENTIVE PROGRAM



DETAILS

- IN-HOME PROVIDERS WHO CARE FOR A MINIMUM OF 2 INFANTS (6 WEEKS-18 MONTHS) WILL RECEIVE \$200 PLUS ANOTHER \$100 IF THEY HAVE 3 INFANTS PER MONTH. MAXIMUM \$300 PER MONTH
- CENTERS WHO CARE FOR A MINIMUM OF 6 INFANTS (6 WEEKS-18 MONTHS) WILL RECEIVE \$200 PLUS ANOTHER \$200 IF THEY HAVE 7 PER MONTH. MAXIMUM \$400 PER MONTH



REQUIREMENTS:

- PROVIDERS WISHING TO PARTICIPATE IN THIS PROGRAM MUST HOLD A VALID LICENSE
- ATTAIN A MINIMUM OF LEVEL 1 CERTIFICATION IN STEP UP TO QUALITY WITH INTENTIONS TO BECOME STEP 2 WITHIN 12 MONTHS.
- IF THE PROVIDER COMPLETES EVERYTHING WITHIN 6 MONTHS TO MOVE TO STEP 2 THEY WILL RECEIVE A \$200 INCENTIVE.



HOLDREGE, NEBRASKA

(720) 939-3436

WWW.HOLDREGEAREAECIP.COM

HOLDREGE AREA EARLYCHILDHOOD PARTNERSHIP

EXTENDED HOURS INCENTIVE PROGRAM



DETAILS:

- THE CHILDCARE FACILITY COMMITS TO OFFERING CHILDCARE SERVICES FROM 5:30 AM TO 7:30 PM FOR THE BENEFIT OF PARENTS/EMPLOYEES OF THE BUSINESSES INVOLVED IN THIS PROGRAM.
- THE CHILDCARE FACILITY WILL RECEIVE AN INCENTIVE PAYMENT OF (\$175) PER MONTH FOR THE PROVISION OF EXTENDED HOURS CHILDCARE SERVICES. AFTER 15 EXTENDED HOURS (ANYTIME BEFORE 7:00AM OR AFTER 5:30PM) THE CHILDCARE CENTER WILL THEN RECEIVE ANOTHER \$175 PER MONTH. HOURS WILL BE RECORDED ON THE ROSTER TO BE TURNED IN ON THE 1ST OF EACH MONTH. MAXIMUM AMOUNT PER MONTH IS \$350.

REQUIREMENTS:

- PROVIDERS WISHING TO PARTICIPATE IN THIS PROGRAM MUST HOLD A VALID LICENSE.
- ATTAIN A MINIMUM OF LEVEL 1 CERTIFICATION IN STEP UP TO QUALITY WITH INTENTIONS TO BECOME STEP 2 WITHIN 12 MONTHS.
- IF THE PROVIDER COMPLETES EVERYTHING WITHIN 6 MONTHS TO MOVE TO STEP 2 THEY WILL RECEIVE A \$200 INCENTIVE.



HOLDREGE, NE

(720) 939-3436

WWW.HOLDREGEAREAECIP.COM





Thank You

Contact us: Holdregeareaecp@gmail.com



Holdrege Area Early
Childhood Partnership, Inc.
EST. 2024